



**MUSICAVC-100Z**  
**IMPEDANCE MATCHING VOLUME CONTROL**  
**OWNER'S MANUAL**

## **IMPEDANCE MATCHING STEREO VOLUME CONTROL**

1. Determine the minimum impedance of the amplifier. This information may be found in the manual or on the back of the amplifier, near the speaker terminals. It is measured in Ohms ( $\Omega$ ).
2. Calculate the total number of speaker pairs to be used.
3. Determine the correct switch setting using the chart below.
4. Set the switch before mounting in the wall, making sure that each volume control's switch setting is consistent throughout the entire system.

The switch must be set correctly to match the impedance of the speaker system to a level equal to or greater than the impedance of the amplifier to prevent overloading and damaging the amplifier.

No. of 8 $\Omega$ Pairs	1	2	3	4	5	6	7	8
Switch Settings	1x	2x	4x	4x	8x	8x	8x	8x

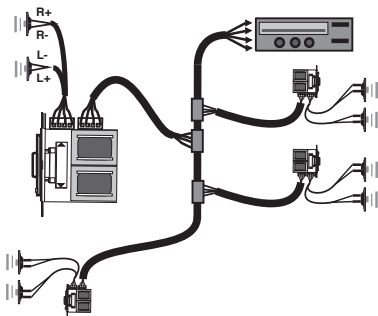

## **INSTALLATION INSTRUCTIONS**

1. Route the cable into the volume control J-box in a way that allows for easy access to the connectors on the MUSICAVC-100Z.
2. Make sure to use the integral strain reliefs where appropriate when routing the cable in the J-box.
3. Mark the input and output cables accordingly for easy installation.
4. Strip the insulation off the end of each of the eight individual wires (four from the amplifier and four to the speakers) at about  $\frac{1}{4}$ ". Twist exposed ends together.
5. Connect the leads from the amplifier to the volume control connector according to the labeled input L [+ , -] and R [+ , -].
6. Connect the speakers wires to the connector labeled Output L [+ , -] and R [+ , -].
7. Insert the volume control into the J-box. Mount carefully, making sure that no wires are pinched or shorted.

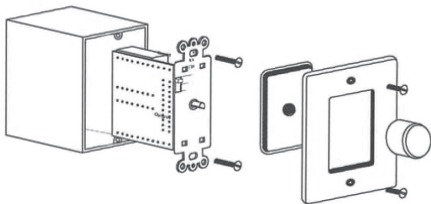

## **LIMITED WARRANTY**

MTX products purchased in the USA from an authorized MTX dealer are guaranteed against defects in material and workmanship for the period of time specified below, the warranty period begins the day the product is purchased by the end user. This warranty is limited to the original retail purchaser of product and extends only to products purchased from authorized MTX resellers. Product found to be defective during that period will be repaired or replaced by MTX at no charge. This warranty is void if it is determined that unauthorized parties have attempted repairs or alterations of any nature. Warranty does not extend to cosmetics or finish. Before presuming a defect is present in the product, be certain that all related equipment and wiring is functioning properly. What You Must Do to Obtain Warranty Service

You must contact Mitek Warranty via our website at [MTX.com](http://MTX.com), or via email at [mitekwarranty@mitekusa.com](mailto:mitekwarranty@mitekusa.com), or by calling 800-556-2888. If you did not purchase the product directly from Mitek, a proof of purchase must be provided in order to receive warranty consideration. You will be issued a Return Authorization (RA) number which must be written on the outside of the package before returning the product to Mitek.

Any assistance Mitek provides to or procures for you outside the terms, limitations or exclusions of this limited warranty will not constitute a waiver of such terms, limitations or exclusions, nor will such assistance extend or revive the warranty. Mitek will not reimburse you for any expenses incurred by you in repairing or replacing any defective product, except for those incurred with Mitek's prior written permission.

For complete warranty information visit [mtx.com/warranty](http://mtx.com/warranty).

© 2018 Mitek Corporation. All rights reserved. MTX is a trademark of Mitek Corporation. Due to continual product development, all specifications are subject to change without notice. MTX Audio, 4545 East Baseline Rd. Phoenix, AZ 85042 U.S.A. 1-800-225-5689  
MTX005825 RevB 8/18 • 21A10684 • AW0015683