

# Z-SIGN

## Wireless Privacy Transceiver



### Features

- Basic Set-up and Pairing to Z2 / Z4 Base Units
- Wireless Enhanced Speech Privacy Remote Activation
- Enhanced Speech Privacy Visual Indicator
- Over 100 ft Transmission Distances via 915MHz ISM Band
- BLE® Integration for Use with iOS® or Android® App
- Can be Mounted on a Wall or Placed on a Desktop
- Out of Range Indication
- Low Battery Indication
- Rechargeable Batteries
- Can Be Used as a Sign Only
- Brightness Adjustment
- Battery Saving Operating Modes
- Can be Used with ASP-MG2240S Enhanced Privacy LED Wired Sign

### Applications

- Medical Office Lobby Check-In
- Conference Rooms
- Open Office Privacy Zones
- Medical Facilities
- Huddle Rooms

### General Description

The AtlasIED Z-SIGN is a wireless transceiver used with the Z Series Z2 & Z4 base units to remotely activate the Z Series Speech Privacy Enhancement mode for applications where secure speech privacy is required. The Z-SIGN also visually indicates when the room is in Speech Privacy Enhancement mode. The optional Z-SIGN can be mounted on a wall or placed on a desk. The Z-SIGN can be powered via rechargeable batteries or by a 5V DC power supply. Speech Privacy Enhancement mode applies additional acoustical energy to the surrounding environment, increasing the privacy levels for the conference room occupants. AtlasIED has been developing, manufacturing, assisting and commissioning sound masking systems for over forty years using proprietary Chanaud masking filters. These unique secured speech filters have been approved and implemented in many installations around the world including military and government facilities.

The Z-SIGN can be used in three different operations. The most common use for the Z-SIGN is to be used as a wireless switch to activate the Speech Privacy Enhancement mode in a Z Series unit. This application also serves as visual indicator showing when speech privacy is engaged. The Z-SIGN can also be used strictly as a visual indicator with the activation button being disabled. In this application, it is common for the Z-SIGN to be used as a second or third visual indicator in a meeting room. Finally, the Z-SIGN can be used as a data transmission / receiving conduit between a mobile device and a Z Series unit. The Z-SIGN incorporates BLE® communication technology for pairing to a mobile device for short distance data communication (not streaming audio), and uses 915MHz ISM Band to transmit longer distances to a Z Series unit. The Z Series mobile app is needed for this function. Using the mobile app with a Z-SIGN allows for mobile control of the Z Series unit and status of the Z system.



## Panels

1. Settings A Button
2. Settings B Button
3. Privacy Activation Button
4. Micro USB Charge Port or Direct Power and PC Firmware Upload
5. Removable Mounting Plate
6. Battery Tab
7. Battery Door and Screw (Use Only NiMH 1000-1100mAh Rechargeable Batteries)
8. Firmware Label
9. Serial Number
10. Displayed Color Functions

## Z Series Wireless Communication

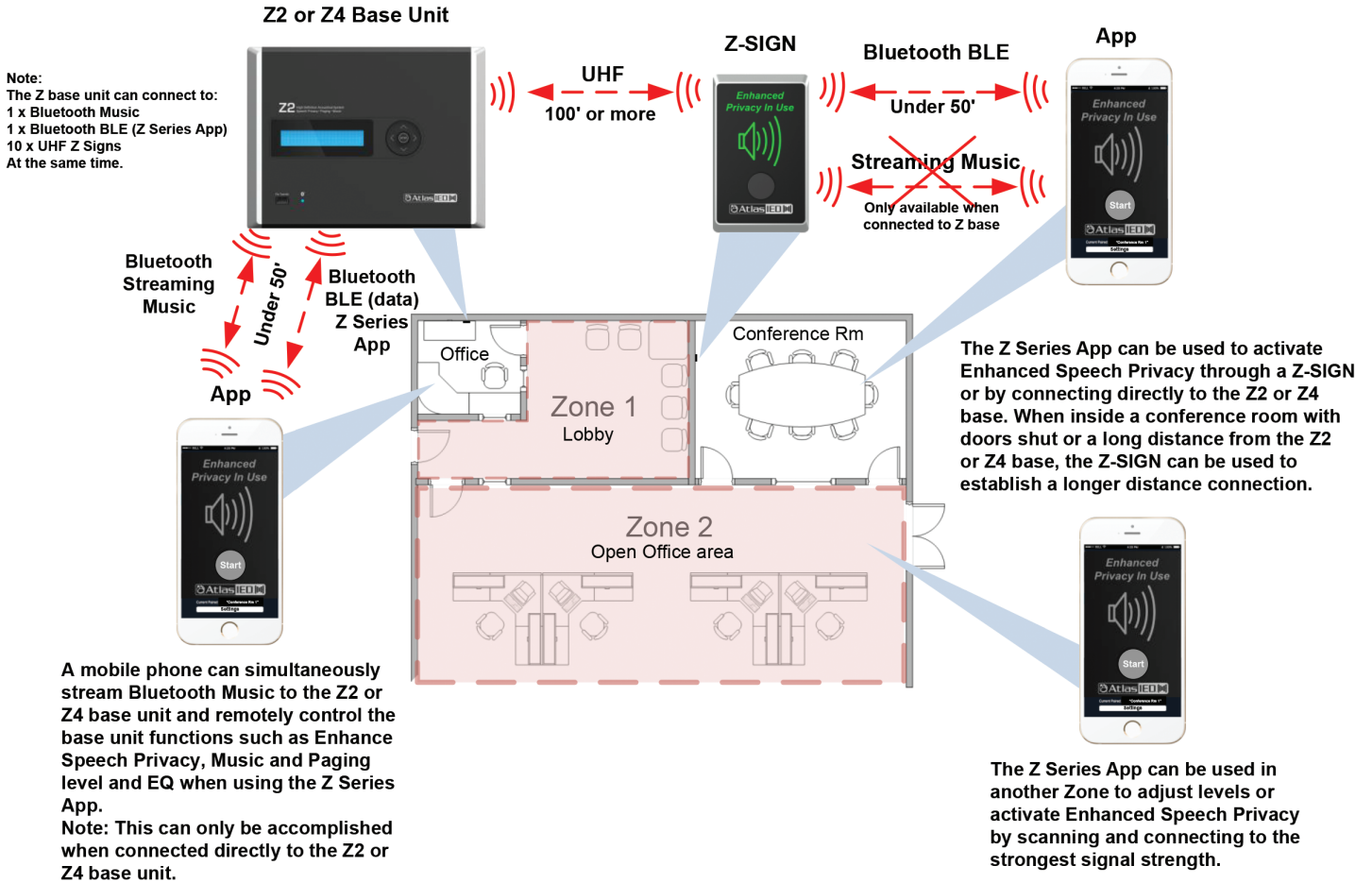

System	
Type	Wireless Transceiver for Z Series
Electrical Specifications (General)	
Batteries	STD 4 x AAA 1000-1100mAh NiMH Rechargeable
UHF-TX/RX	915MHz ISM Band, Will Pair Up to 10 Signs Max
BLE®	Yes, iOS® & Android® Control App
Charging PSU	Micro USB 100V - 240V AC to 5V 1A DC
Activation	Manual Button & iOS® or Android® App
Display	LED Light Panels x 2 Upper / Lower - RGB
Options A & B	LED Brightness; Activation Disable; Reset to Factory
Operating Modes (3)	#1 Green - Single Sign (default); #2 Yellow - Single Sign + App; #3 Red - Multi-Sign + App
Low Battery	Red Blink - Every 15 Seconds
Charging Indication	Purple Blink - Every 10 Seconds When Charging, Off When Charged
Enhanced Privacy	Speaker Wave Icon Heart-Beat Pulse When Active
Out of Range	Blue Blink
Reset	Hold A & B 6 Seconds = 4 Red Blinks, Disconnects Pairing to Z Series Base Unit
Mechanical	
Dimensions (HxWxD)	4.5" x 2.76" x 0.79" (114mm x 70mm x 20mm)
Unit Weight	0.36lb (0.164kg)
Shipping Weight	0.68lb (0.310kg)
Mount	Removable Mount
Battery Door	On Rear - Screw Fastened
Other	
Package Contents	Z-SIGN with Peel-Off Protective Film Overlay Qty 1 Micro USB Charger Qty 1 Mount Qty 1 Mount Screws Qty 2 Spare Battery Door Screw Qty 1 Double-Sided 3M® Mounting Foam

©2019 Atlas Sound LP. The Atlas "Circle A", Soundolier, and Atlas Sound are trademarks of Atlas Sound L.P. IED is a Registered Trademark of Innovative Electronic Designs LLC. All rights reserved. All other Trademarks are property of their respective owners. No endorsement is implied. Due to continual product development, specifications are subject to change without notice. ATSO05921 RevA 2/19

## Dimensional Drawings

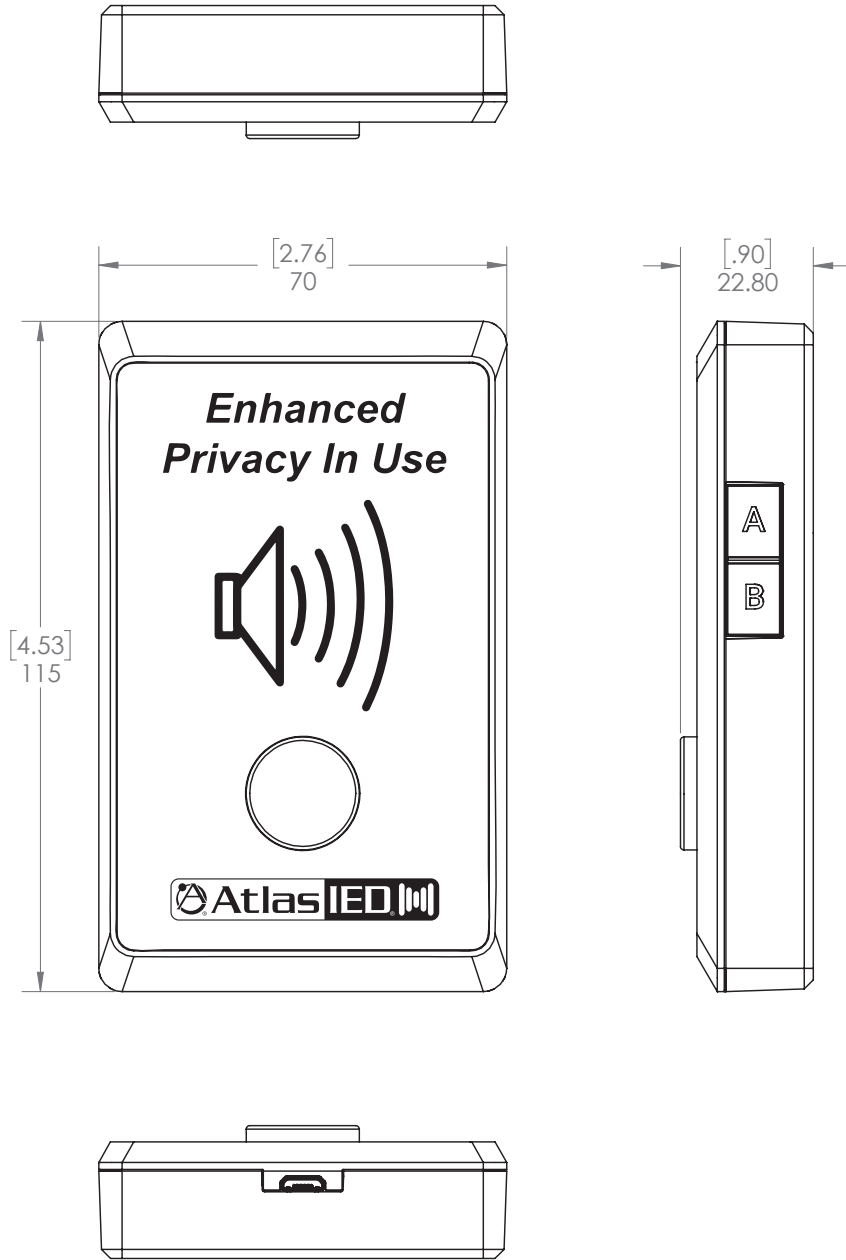

## Architect and Engineer Specifications

The AtlasIED Model Z-SIGN transceiver shall be an optional accessory item used with Z2 & Z4 amplified multi zone speech privacy, sound masking, paging, and BGM systems. The Z-SIGN shall provide remote activation to the Z2 & Z4 base units Speech Privacy Enhancement mode. The Z-SIGN shall provide visual indication when Speech Privacy Enhancement is engaged. Multiple Z-SIGN units shall be able to be paired and work in sync with the Z2 & Z4 base units.

The Z-SIGN shall transmit and receive data from the Z Series Z2 & Z4 base units in the 915MHz ISM band. The Z-SIGN shall communicate to iOS® / Android® app via BLE® technology. The Z-SIGN Speech Privacy Enhancement activation switch shall be able to be disabled. The Z-SIGN shall have luminary brightness adjustments via control buttons.

The Z-SIGN shall be powered via 4 AAA rechargeable NiMH batteries or a 5VDC power supply. The Z-SIGN shall have application specific battery life saving operating modes. The Z-SIGN battery level shall be monitored via the Z Series app or via LED indication on the Z-SIGN. The Z-SIGN shall have out of range LED indication to the Z2 & Z4 base units. The Z-SIGN shall be mounted on the wall via detachable wall mounting clip or placed onto a desk / table.

Dimensions shall be H 4.5" x W 2.76" x D 0.79" (114mm x 70mm x 20mm). Weight shall be 0.36lbs (0.164kg). Warranty coverage shall be 1 year. The unit shall be FCC marked, RoHS / WEEE and CE compliant. The Z2 & Z4 shall meet low voltage wiring standards. The Z-SIGN shall be the optional wireless transceiver to the Z2 & Z4 High Definition Acoustical Systems for speech privacy, sound masking, paging, and BGM amplification.